

### Housing(Right angle type)

1. Part No.: 2509xxHR001
2. Part Name: 2509 Housing
3. Material: Nylon 66 UL 94V0
4. Color: Natural

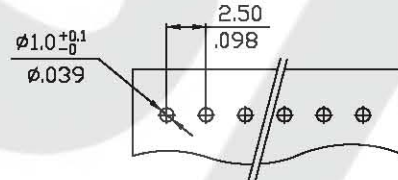
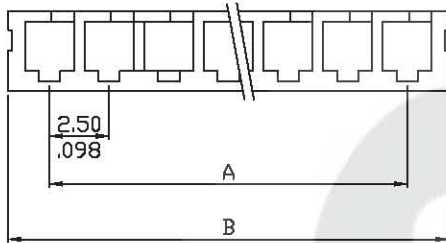
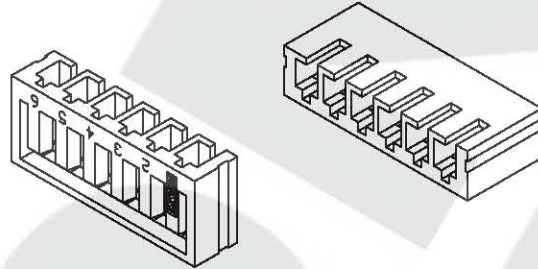

#### RECOMMENDED PCB LAYOUT

(PCB T=0.8~1.6mm)  
(PCB T=.031~.063in)

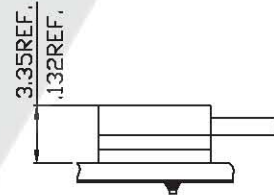
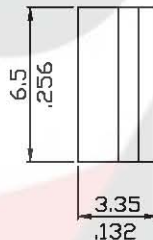
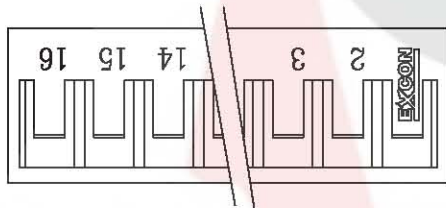

#### Mating Dimensions

### Ordering Information and Dimensions:

Part No.	Circuits	Dim A	Dim B	Part No.	Circuits	Dim A	Dim B
250902HR001	2	2.5(.098)	5.95(.234)	250910HR001	10	22.5(.886)	25.95(1.022)
250903HR001	3	5.0(.197)	8.45(.333)	250911HR001	11	25.0(.984)	28.45(1.120)
250904HR001	4	7.5(.295)	10.95(.431)	250912HR001	12	27.5(1.083)	30.95(1.219)
250905HR001	5	10.0(.394)	13.45(.530)	250913HR001	13	30.0(1.181)	33.45(1.317)
250906HR001	6	12.5(.492)	15.95(.628)	250914HR001	14	32.5(1.280)	35.95(1.415)
250907HR001	7	15.0(.591)	18.45(.726)	250915HR001	15	35.0(1.378)	38.45(1.514)
250908HR001	8	17.5(.689)	20.95(.825)	250916HR001	16	37.5(1.476)	40.95(1.612)
250909HR001	9	20.0(.787)	23.45(.923)				

#### Part Code Information:

2509-WW XX YYY

① ② ③ ④

① Series Name

② Circuits Number

02~16

③ Product Type

HR=Housing (Right angle type)

④ Material/Finishing/Color

001=NY66 UL94V0,Color,Natural

### ■ Specifications

1. Current rating: 2.5A AC/DC
2. Voltage rating: 250V AC/DC
3. Withstand voltage: 800V AC/minute
4. Insulation resistance: 1000M  $\Omega$  min
5. Contact resistance: 20m  $\Omega$  max
6. Temperature range: -25°C to +105°C
7. Applicable PC board thickness: 0.8~1.6mm(.031" to .063")
8. Applicable wires: AWG#28-#22  
Insulation O.D.: 1.2-1.9mm
9. Circuits: 2~16 circuits available

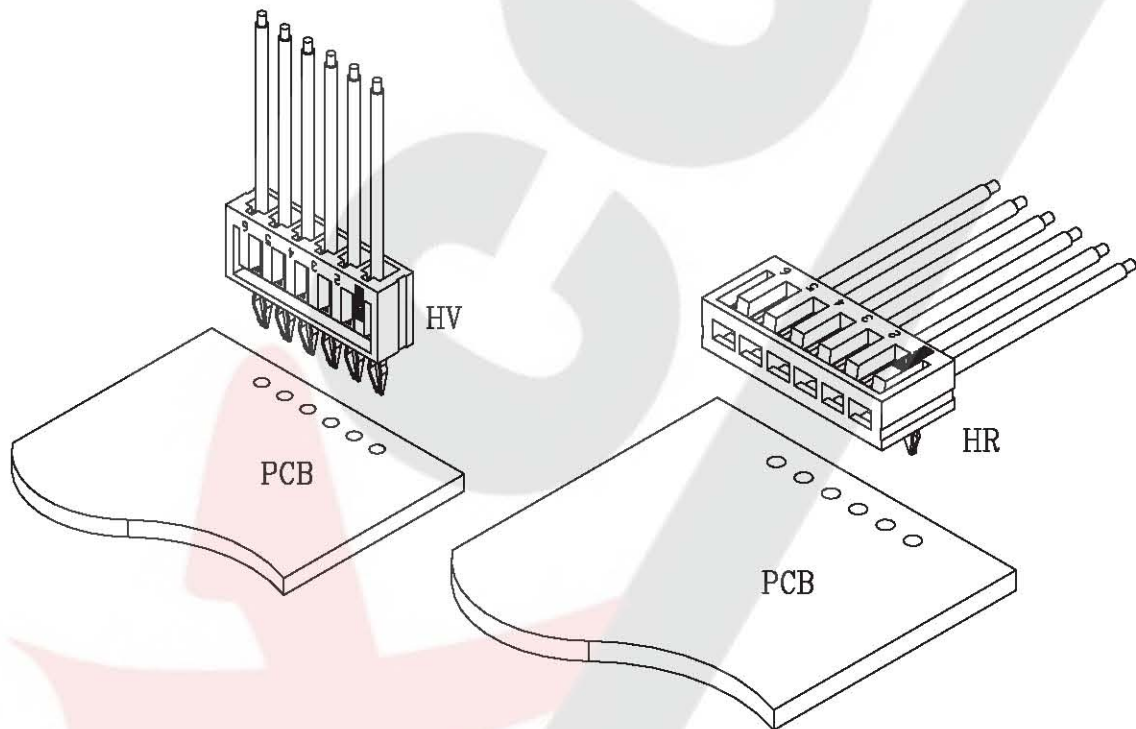

### Part Code Information:

2509-WW XX YYY

① ② ③ ④

① Series Name

② Circuits Number

02~16

00 For Terminal

③ Product Type

HV=Housing (Vertical type)

HR=Housing (Right angle type)

TV=Terminal (Vertical type)

TR=Terminal (Right angle type)

④ Material/Finishing/Color

351=Phosphor,Tin Pre-Plated

301=Phosphor,Tin Plated

001=Brass, Tin Plated

051=Brass, Tin Pre-Plated

001=NY66 UL94V0,Color,Natural

### Crimp Terminal(Vertical type)

1. Part No.: 250900TV001,250900TV301
2. Part Name: 2509 Terminal
3. Material: Phosphor bronze or Brass
4. Finishing: Tin plated, Tin pre-plated

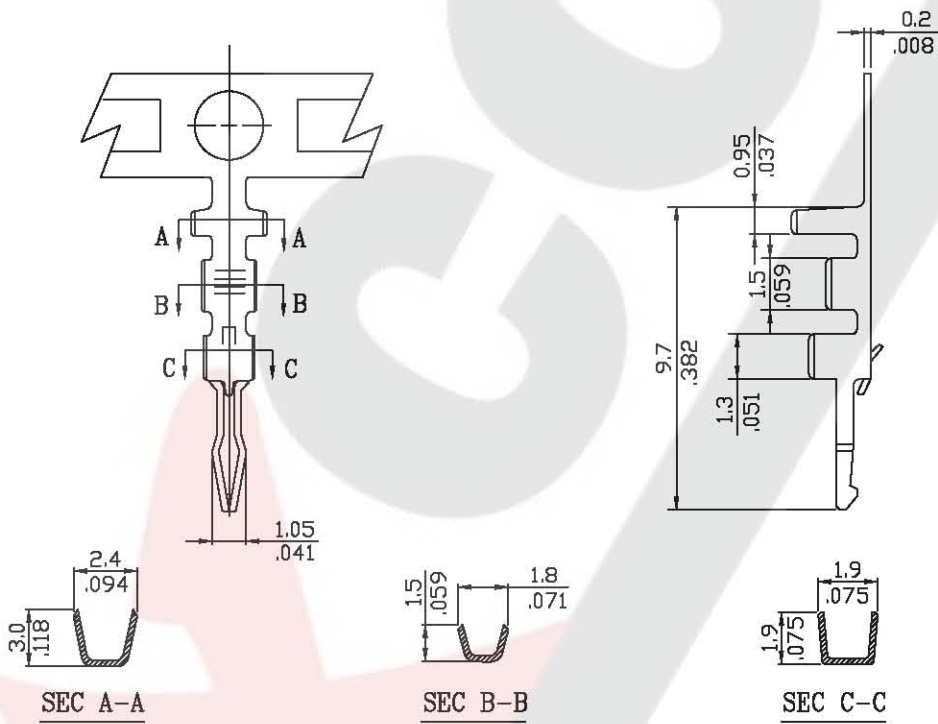
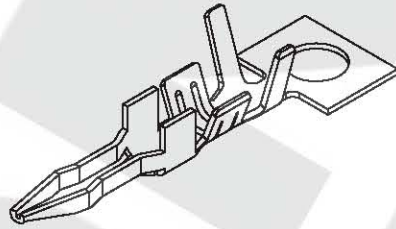

### Ordering Information and Dimensions:

Part No.	Wire Range	Insulation O.D.	Material	Finishing	Q'ty/reel
250900TV001	AWG#28~#22	1.2-1.9mm	Brass	Tin plated	10,000pcs
250900TV051				Tin pre-plated	
250900TV301			Phosphor	Tin plated	10,000pcs
250900TV351				Tin pre-plated	

### Part Code Information:

2509-WW XX YY

① ② ③ ④

① Series Name

② Circuits Number

00 For Terminal

③ Product Type

TV=Terminal (Vertical type)

④ Material/Finishing/Color

351=Phosphor,Tin Pre-Plated

301=Phosphor,Tin Plated

001=Brass, Tin Plated

051=Brass, Tin Pre-Plated

### Housing(Vertical type)

1. Part No.: 2509xxHV001
2. Part Name: 2509 Housing
3. Material: Nylon 66 UL 94V0
4. Color: Natural

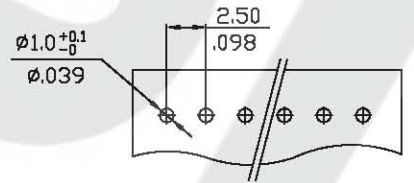
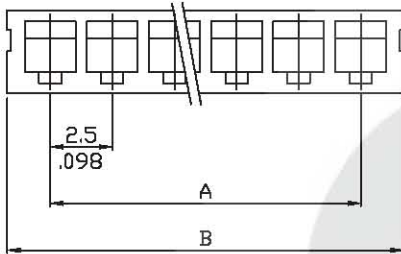
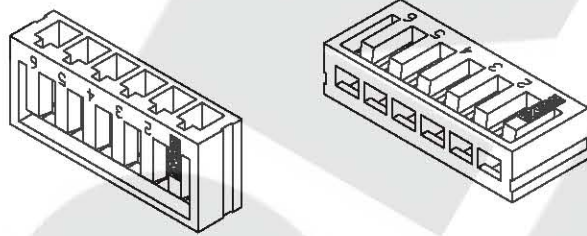

**RECOMMENDED PCB LAYOUT**

(PCB T=0.8~1.6mm)  
(PCB T=.031~.063in)

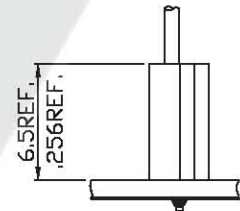
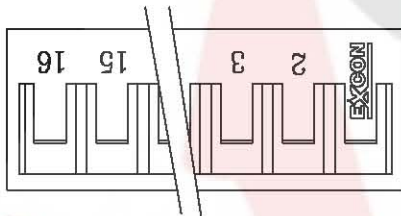

**Mating Dimensions**

### Ordering Information and Dimensions:

Part No.	Circuits	Dim A	Dim B	Part No.	Circuits	Dim A	Dim B
250902HV001	2	2.5(.098)	5.95(.234)	250910HV001	10	22.5(.886)	25.95(1.022)
250903HV001	3	5.0(.197)	8.45(.333)	250911HV001	11	25.0(.984)	28.45(1.120)
250904HV001	4	7.5(.295)	10.95(.431)	250912HV001	12	27.5(1.083)	30.95(1.219)
250905HV001	5	10.0(.394)	13.45(.530)	250913HV001	13	30.0(1.181)	33.45(1.317)
250906HV001	6	12.5(.492)	15.95(.628)	250914HV001	14	32.5(1.280)	35.95(1.415)
250907HV001	7	15.0(.591)	18.45(.726)	250915HV001	15	35.0(1.378)	38.45(1.514)
250908HV001	8	17.5(.689)	20.95(.825)	250916HV001	16	37.5(1.476)	40.95(1.612)
250909HV001	9	20.0(.787)	23.45(.923)				

Part Code Information: ③ Product Type

2509-WW XX YYY

① ② ③ ④

① Series Name

② Circuits Number

02~16

HV=Housing (Vertical type)

④ Material/Finishing/Color

001=NY66 UL94V0,Color,Natural

### Crimp Terminal(Right angle type)

1. Part No.: 250900TR001,250900TR301
2. Part Name: 2509 Terminal
3. Material: Phosphor bronze or Brass
4. Finishing: Tin plated, Tin pre-plated

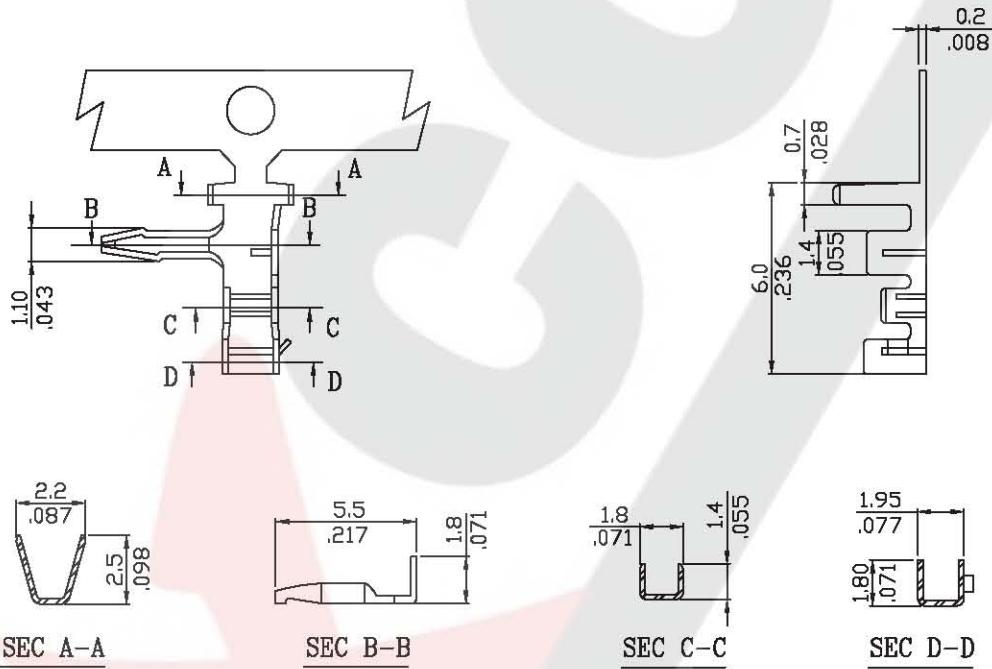
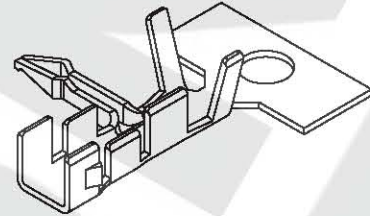

### Ordering Information and Dimensions:

Part No.	Wire Range	Insulation O.D.	Material	Finishing	Q'ty/reel
250900TR001	AWG#28~#22	1.2-1.9mm	Brass	Tin plated	10,000pcs
250900TR051				Tin pre-plated	
250900TR301			Phosphor	Tin plated	10,000pcs
250900TR351				Tin pre-plated	

### Part Code Information:

2509-WW XX YY

① ② ③ ④

① Series Name

② Circuits Number

00 For Terminal

③ Product Type

TR=Terminal (Right angle type)

④ Material/Finishing/Color

351=Phosphor,Tin Pre-Plated

301=Phosphor,Tin Plated

001=Brass, Tin Plated

051=Brass, Tin Pre-Plated